

## STORMWATER NOTES

- PRIOR TO COMMENCEMENT OF THE WORK THE LOCATION OF EXISTING DRAINAGE PIPES SHALL BE VERIFIED
- THE PROPOSED ROOF DRAINAGE SHALL BE VIA GRAVITY SYSTEM.
- EROSION AND SEDIMENT CONTROL DEVICES SHALL BE IN ACCORDANCE WITH COUNCILS REQUIREMENTS.
- THE STORM WATER DRAINAGE MATERIALS, INSTALLATION AND TESTING SHOULD BE IN ACCORDANCE WITH AS 3500.3, 1998 AND ASSOCIATED AUSTRALIAN STANDARDS.
- THE DRAINAGE DRAWNGS SHALL BE READ IN CONJUNCTION WITH RELEVANT ARCHITECTURAL AND STRUCTURAL DRAWINGS.
- THE STORM WATER DRAINAGE PIPE LAYOUT IS DIAGRAMMATIC ONLY. THE ACTUAL LAYOUT SHALL DEPEND ON THE FINISHED SURFACE LEVELS. THE CONTRACTOR SHOULD TAKE CARE DURING THE CONSTRUCTION WORK.
- PROPOSED DRAINAGE LEVELS ARE TO BE CHECKED PRIOR TO COMMENCEMENT OF ANY WORKS. ANY DISCREPANCY SHALL BE BOUGHT TO THE ENGINEERS ATTENTION.
- ALL STORM WATER SHALL HAVE A MINIMUM GRADE OF 1% UNLESS OTHERWISE SPECIFIED. USE INVERT LEVELS FOR CONSTRUCTION WORK.
- ALL DRAINAGE LAID UNDER PAVING SHALL BE BACKFIELD WITH SAND.
- DIRECT ALL SURFACE RUNOFF TO INLET PITs.
- THE DEPTHS OF THE INLET PITs NOMINATED ON THE DRAWING ARE NOMINAL. THIS SHOULD BE VARIED TO SUIT THE FINISHED GROUND LEVEL.
- A LICENSED SURVEYOR SHALL CONFIRM CONSTRUCTED LEVELS.
- CLEAN OUT POINT SHALL BE LOCATED AS SHOWN IN THE PLAN AND BE TERMINATED WITH A SCREW CAP LEGIBLY MARKED 'SW'.
- REPLACE EXISTING DRAIN IF DAMAGED DURING CONSTRUCTION.

## SYDNEY WATER SEWER

- SW1. LOCATION OF THE SEWER LINE SHALL BE OBTAIN FROM SYDNEY WATER.
- SW2. ALL WORK RELATED TO THE SEWER LINE SHALL BE CARRIED OUT BY CONTRACTORS APPROVED BY SYDNEY WATER.
- SW3. ALL WORK SHALL CONFORM TO COUNCIL OF SYDNEY WATER GUIDELINE.

**INSPECTION:**  
ALL STORMWATER WORK SHALL BE INSPECTED APPROVED BY THE ENGINEER. ENGINEER SHALL BE NOTIFIED 2 WORKING DAYS (48 HOURS) PRIOR TO THE INSPECTION.

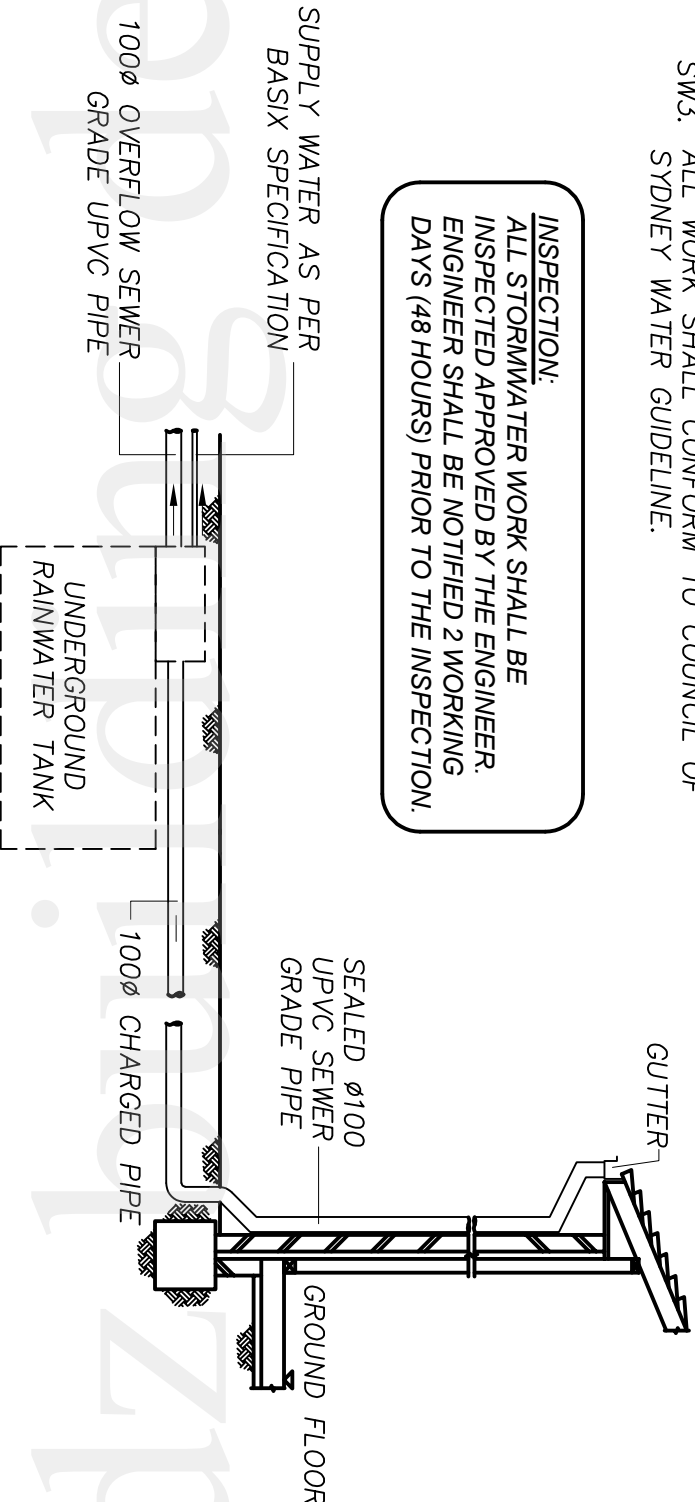

## RAINWATER TANK SYSTEM DETAIL

N.T.S

### DRAWING LIST:

- C-1.00 STORMWATER NOTES, RAINWATER TANK DETAIL, DRAWING LIST
- C-2.00 STORMWATER DRAINAGE CONCEPT PLAN
- C-2.01 ARRESTOR PIT, PIT-2 AND AG LINE DETAILS

1	FOR CONSTRUCTION CERTIFICATE	2.08.2024
Issue	Revision Description	Date

<b>DZ BUILDING DESIGN SERVICE</b> CIVIL & STRUCTURAL ENGINEERING CONSULTING			<b>FOR CONSTRUCTION APPLICATION</b>		
502/32 Shepherd Street, Liverpool, N.S.W. 2170 PH: (02) 8119 5200 FAX: (02) 8119 5200 Mobile: 0402 043 001 E-mail: david@dzbuildingdesignservice.com www.dzbuildingdesignservice.com ABN 15045861806			Client: <b>RUGRA PTY. LTD</b> Address: <b>No.199 William St, Earlwood, NSW 2206</b> Drg. Title: <b>STORMWATER NOTES, DRAWING LIST</b>		
Architect: <b>M GROUPE</b> Suite 3F-1, 4 Belgrave Street, Kogarah, NSW 2217 Tel: (02) 95538777, Mobile: 0411035824 Email: john@mgroupe.com.au			Designed: <b>DAVID</b> Drawn: <b>DZ</b> Date: <b>Aug, 2024</b> Scale: <b>NTS</b>		
Project / Project Address: <b>PROPOSED BOARDING HOUSE</b> <b>AT 199 William St, Earlwood, NSW 2206</b> <b>Lot/Section/Plan No: 72-/DP9186</b>			Checked: <b>W.ZHOU</b> Drawing No: <b>C-1.00</b> JOB NO.: <b>S2434</b> North Point		
 ENGINEERS AUSTRALIA Professional Engineers MEMBER 3078954					

This drawing is copyright and must not be retained, copied or used without the express authority of DZ Building Design Service.

5000 (L) IN-GROUND RAINWATER TANK TO BE CONNECTED TO HOUSEHOLD INTERNAL USE, OVERFLOW INTO ARRESTOR PIT.

125x75x4 RHS @1% (min) SLOPE DISCHARGE TO THE OPEN CHANNEL. OUTLET PIPE LEVEL TO BE CONFIRMED

ARRESTOR PIT WITH 600x600 HINGED AND GALVANIZED GRATE STEEL LID. SL 26.20m IL 25.45m

INTERNAL PIT-2 WITH 450x450 HINGED AND GALVANIZED GRATE STEEL LID. SL 26.85m IL 26.40m

200mm WIDE GRATE TRENCH DRAIN COLLECT SURFACE WATER FLOW INTO ARRESTOR PIT.

SURFACE WATER IN CAR SPACE AND DRIVEWAY AREA FLOW TOWARDS REAR INTO GRATED DRAIN TRENCH

ROOF DRAIN SCUPPER SHALL BE INSTALLED THROUGH PARAPET WALL, SPREAD DP DISCHARGE TO LOWER ROOF

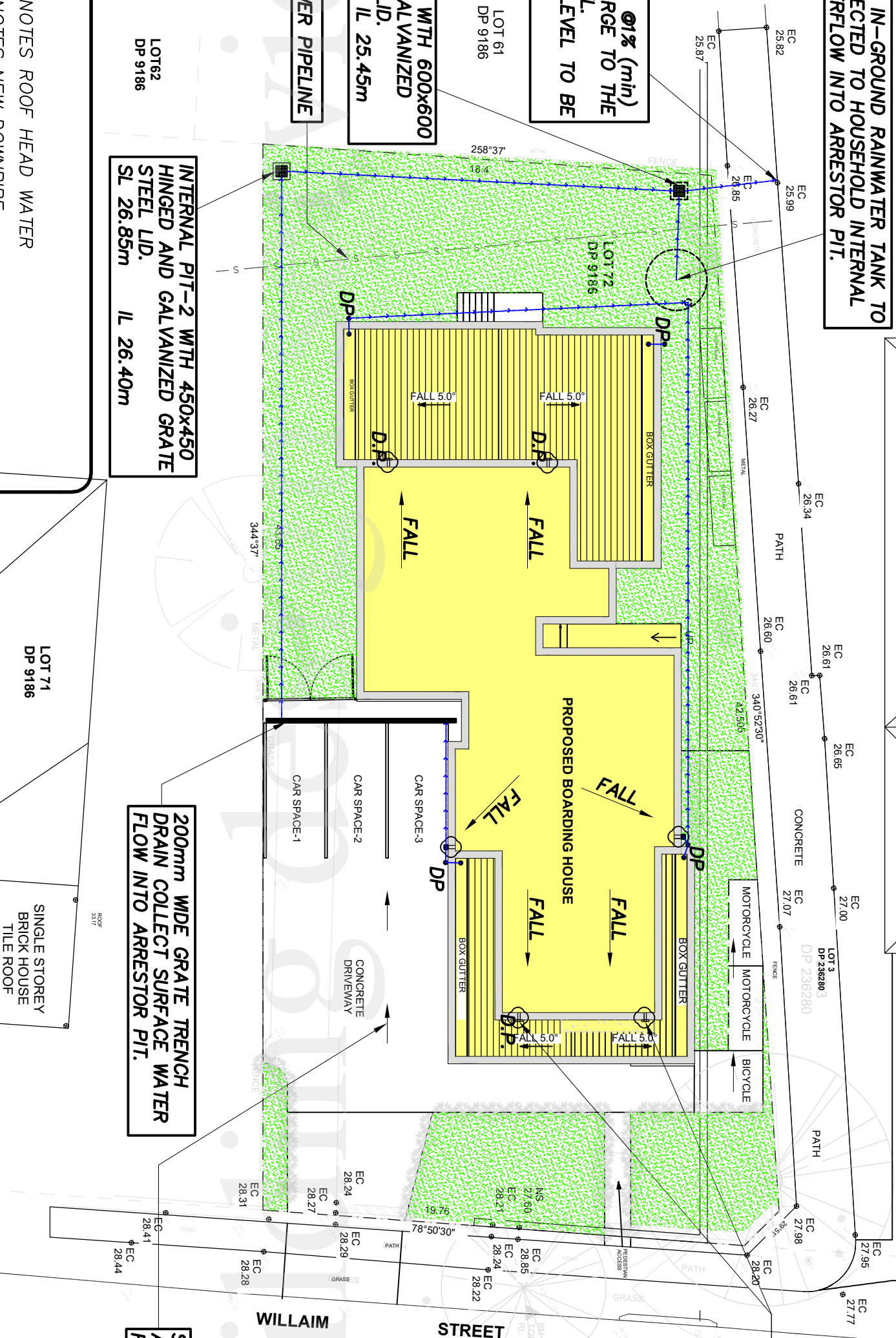

LEGEND:

- RH DENOTES ROOF HEAD WATER
- DP DENOTES NEW DOWNPIPE
- DP DENOTES ROPOSED STORMWATER PIPE – GRAVITY
- DP DENOTES PROPOSED STORMWATER PIPE – CHARGED
- DP DENOTES SUB-SOIL AGGREGATE LINE
- DP DENOTES ARRESTOR PIT
- DP DENOTES SILT FENCE

LOT 71  
DP 9186  
SINGLE STOREY  
BRICK HOUSE  
TILE ROOF  
NO.201

STORMWATER CONCEPT DRAINAGE PLAN

SCALE 1:200

(\*ALL STORMWATER PIPE SHOW IN THIS DRAWING IS Ø150 UPVC AND LAID AT A MIN SLOPE OF 1%)

COLOR LEGEND:

- DP DENOTES PROPOSED BUILDING WORK
- DP DENOTES LANDSCAPING

FOR CONSTRUCTION APPLICATION

DZ BUILDING DESIGN SERVICE				Architect: M GROUPE			
CIVIL & STRUCTURAL ENGINEERING CONSULTING				Suite 3F-1, 4 Belgrave Street, Kogarah, NSW 2217			
Registration: PRE0002038, PDP0001125, DEP0003305				Tel: (02) 95538777, Mobile: 0411035824			
				Email: john@mgroupe.com.au			
502/32 Shephard Street, Liverpool, N.S.W. 2170				Project / Project Address:			
PH: (02) 8119 5200 FAX: (02) 8119 5200				PROPOSED BOARDING HOUSE			
Mobile: 0402 043 001				AT 199 William St, Earlwood, NSW 2206			
E-mail: david@dzbuidingdesignservice.com				Lot/Section/Plan No: 72-/DP9186			
www.dzbuidingdesignservice.com							
ABN 15045861806							
3078954							
Professional Engineers AUSTRALIA MEMBER							
ENGINEERS AUSTRALIA							
Professional Engineers							
MEMBER							
3078954							



This drawing is copyright and must not be retained, copied or used without the express authority of DZ Building Design Service.

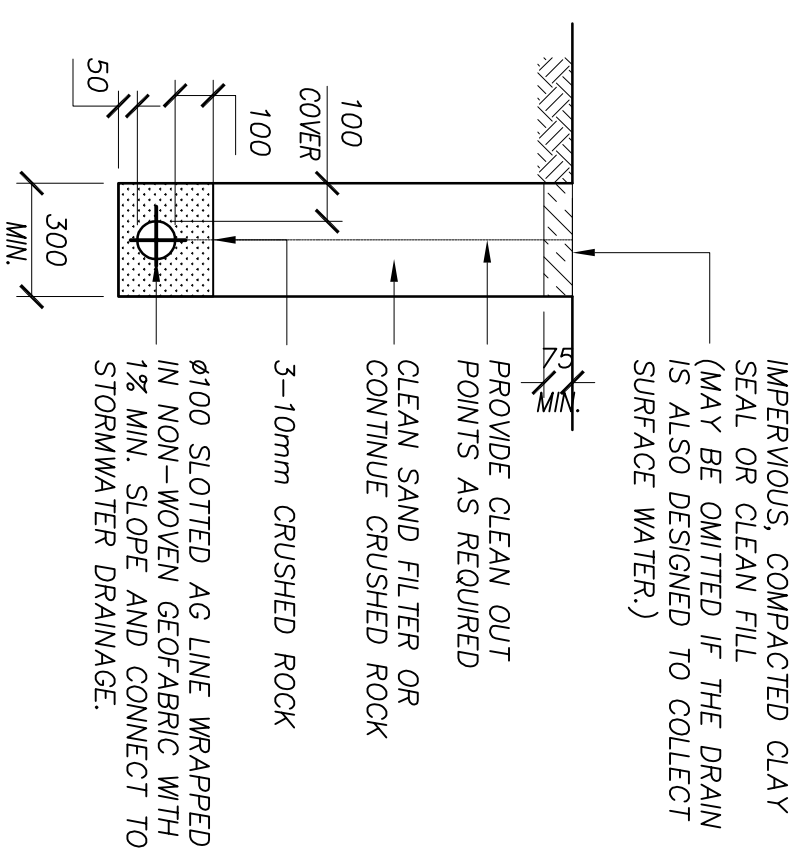
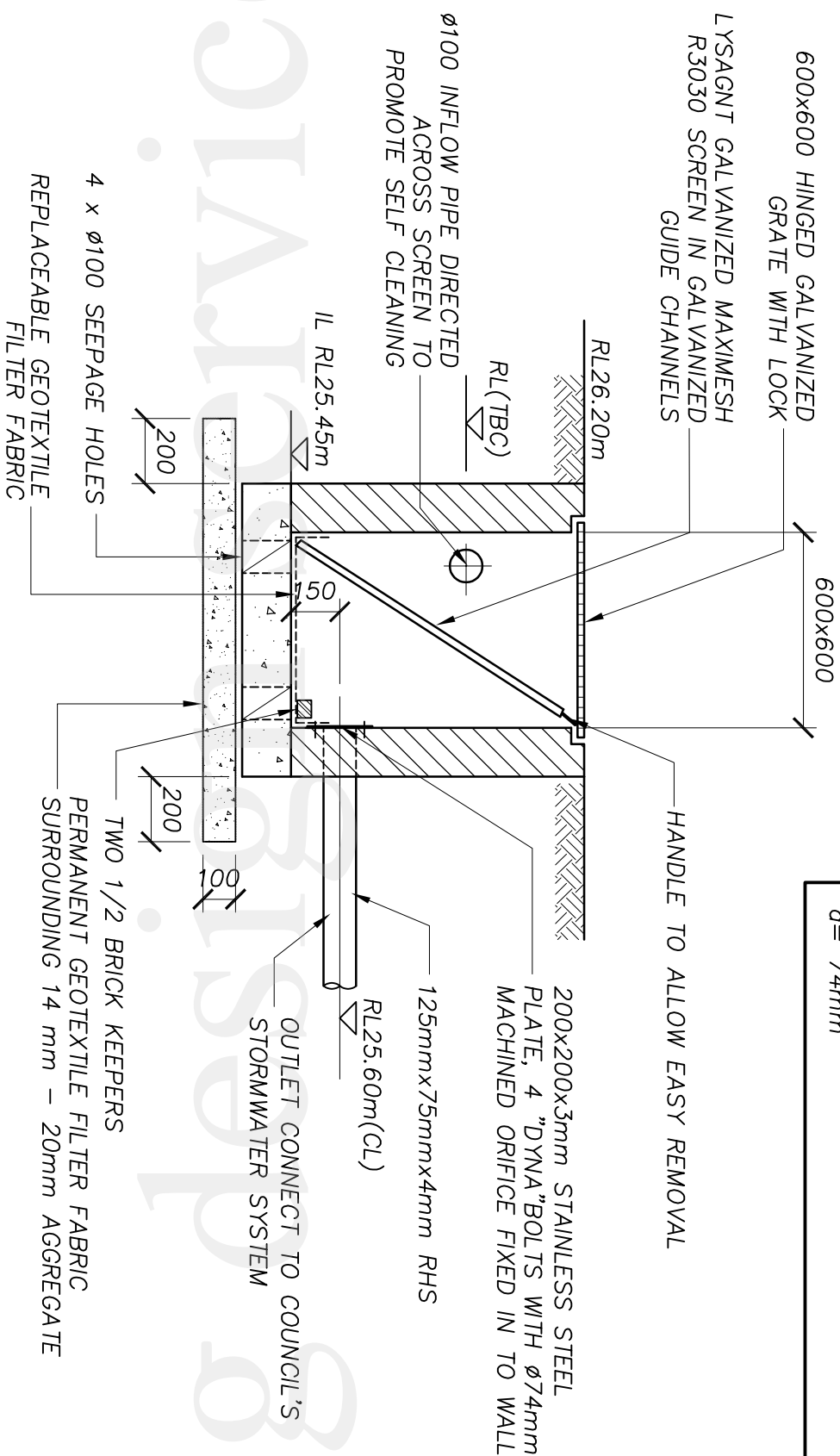

## TYPICAL DETAIL OF AG LINE

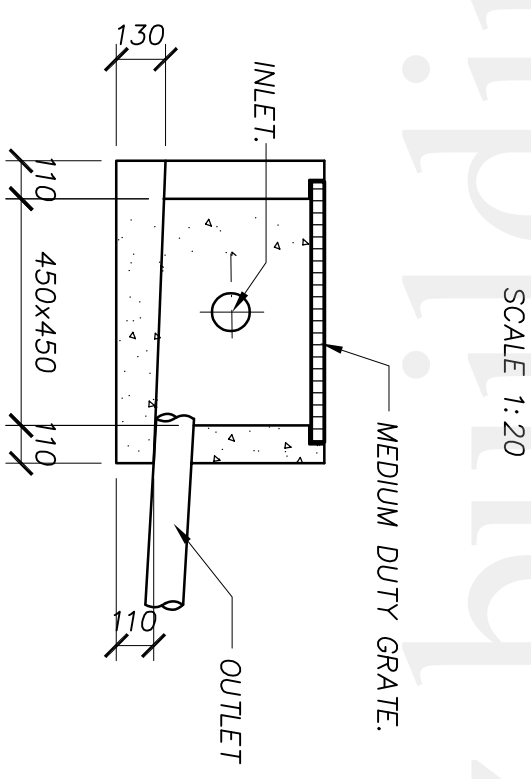

TYPICAL INTERNAL PIT-2

NOTE: TBC INSTEAD OF TO BE CONFIRMED

SCALE 1:20

SILT/LITTER ARRESTOR PIT

[illegible]